

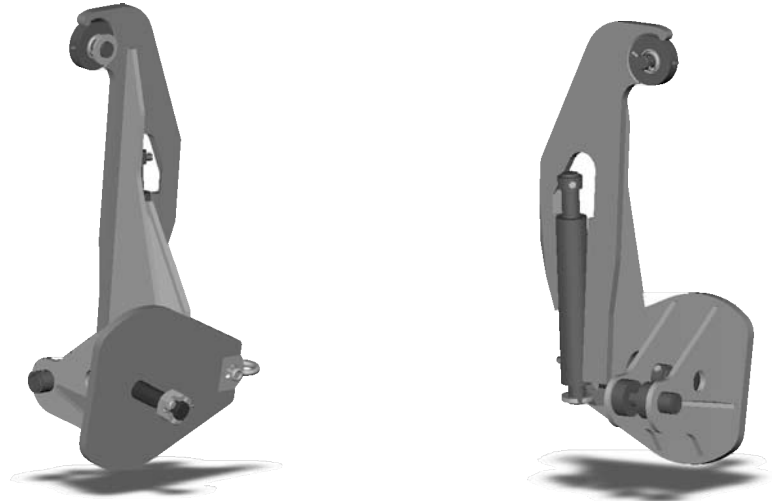

## HTS Hydraulic Trip Swivel for Wing Assembly



### Overview

- Replaces the standard bell swivel on Craig 301 & 302 Series Wing Assemblies
- Hydraulic trip uses a relief valve equipped 3", 1.5" shaft cylinder which provides 4.5" of stroke
- When the moldboard strikes an obstacle the relief valve allows the moldboard to trip forward
- Cylinder can be reset from the cab using hydraulic controls
- Relief valve can be set with a custom threshold to handle varying conditions
- Bell plate swivels on 1.25" and 1.5" cold rolled pins
- Bell plate attaches to mold board with 1.5" x 6" grade 2 replaceable shear bolt
- 1/2" clevis secures the mold board safety chain to the trip swivel

Craig Manufacturing Ltd. warrants to the original purchaser all products manufactured by CRAIG to be free from defects in material and workmanship for a period of (12) months starting from the date of delivery from factory unless otherwise specified.

