

OPERATIONS PROCEDURE FOR CRAIG HYDRAULIC WEDGE LOCK COUPLER WITH CRAIG HYDRAULIC KIT

TOLL FREE TECHNICAL SUPPORT: 1-800-565-5007

ENGAGING ATTACHMENT ONTO COUPLER

UNLOCKING COUPLER TO ENGAGE AN ATTACHMENT

STEP 1:



To unlock the coupler to get it ready to engage an attachment, the first thing that will need to be done is curl the coupler all the way in, as shown in the picture to the left.

CRAIG HYDRAULIC KIT

STEP 2:

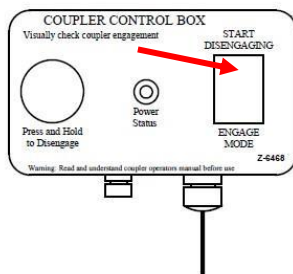

Once the coupler is curled all the way in, flip the rocker switch to “START DISENGAGING”, as shown in the picture to the left. **At this time, the buzzer will start sounding constantly, and the button will light up.**

STEP 3:

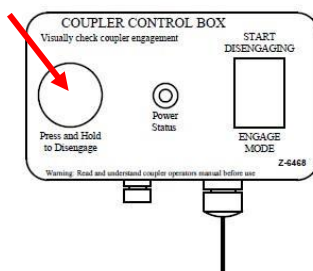

NOTE: The control box will lock out if you wait longer than 5 seconds to hit the button. If that happens, flip the rocker switch back to “ENGAGE MODE”.

Within 5 seconds of flipping the rocker switch, press and hold the disengage button for at least 2 seconds (see picture to the left). **The buzzer will start to beep once every second, and the button will start flashing.** Hold the bucket curl cylinder over relief for at least 5 seconds until you see the coupler fully unlock.

HARLTAND BRANCH
96 McLean Avenue
Hartland, New Brunswick
E7P 2K5 Canada

CAMBRIDGE BRANCH
315 Thompson Drive
Cambridge, Ontario
N1T 2B3 Canada

BLACKFALDS BRANCH
27323-88 Township Road 394
Red Deer County, Alberta
T0M 0J0 Canada

LAWRENCEBURG BRANCH
408 Commerce Way
Lawrenceburg, Tennessee
38456 USA

CRAIG HYDRAULIC KIT

STEP 4:

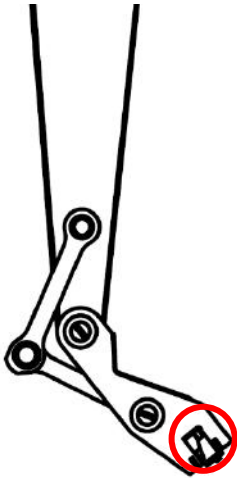

Visually check to make sure that the wedge has extended and out of the way. (See picture to the left) This should be your indication that the coupler is completely unlocked. **The buzzer will continue to beep once every second, to alert you that the coupler is still unlocked.** Now, the coupler is ready to engage onto an attachment.

COUPLER UNLOCKED AND ENGAGING AN ATTACHMENT

STEP 5:

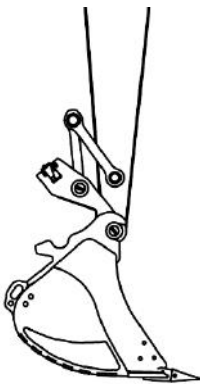

Curl the coupler out so that the front bosses of the coupler can line up with the wedge lock hooks on the attachment you want to pick up. Slide the front bosses into the front wedge lock hook of the attachment. (See picture to the left) It might be easiest to completely curl the coupler out to do this, but that is not a necessity.

STEP 6:

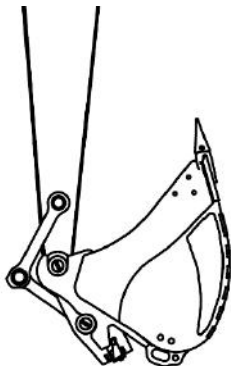

Once the front bosses are in the front wedge lock hook, start to curl the coupler and attachment in. You may have to lift the boom a little to allow the coupler and attachment to curl in. Curl the coupler and attachment all the way in, so that the weight of the attachment is on the coupler, and the rear coupler boss is now contacting the wedge lock hooks. (See picture to the left)

HARLTAND BRANCH
 96 McLean Avenue
 Hartland, New Brunswick
 E7P 2K5 Canada

CAMBRIDGE BRANCH
 315 Thompson Drive
 Cambridge, Ontario
 N1T 2B3 Canada

BLACKFALDS BRANCH
 27323-88 Township Road 394
 Red Deer County, Alberta
 T0M 0J0 Canada

LAWRENCEBURG BRANCH
 408 Commerce Way
 Lawrenceburg, Tennessee
 38456 USA

LOCKING COUPLER ON TO ATTACHMENT

CRAIG HYDRAULIC KIT

STEP 7:

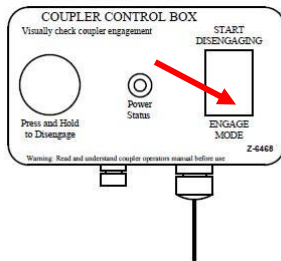

Once the coupler and attachment are curled in, and the rear boss is now hitting the wedge lock hooks, flip the rocker switch to “ENGAGE MODE”. (See picture to the left) **Once the rocker switch is flipped, the buzzer will shut off and the control box will revert to idle mode.** Continue to hold the bucket curl over relief for at least 5 seconds until the coupler locks.

BUMP TEST

STEP 8:

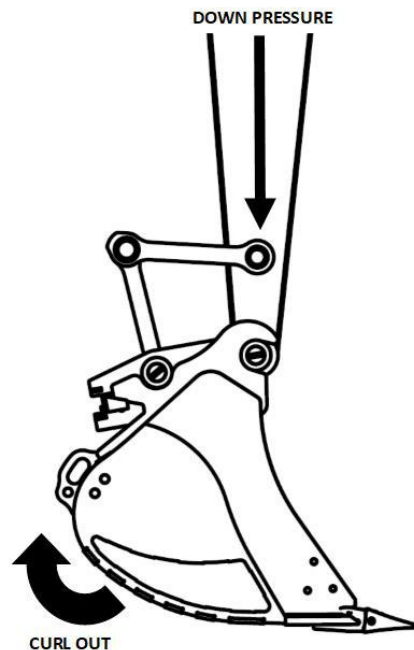

Lastly, a bump test should be done to make sure that the coupler is properly locked on to the attachment. Put the attachment onto the ground, and apply some down pressure using the boom or stick. (See picture to the left) Then, curl the coupler and attachment out while pressing the attachment into the ground, and try to get the rear boss of the coupler to come off the wedge lock hooks. If the coupler moves off the wedge lock hooks drop the attachment and repeat steps 1 through 8.



Do not release or change the attachment near any person or in any areas that may result in an accident or injury occurring.

HARLTAND BRANCH
96 McLean Avenue
Hartland, New Brunswick
E7P 2K5 Canada

CAMBRIDGE BRANCH
315 Thompson Drive
Cambridge, Ontario
N1T 2B3 Canada

BLACKFALDS BRANCH
27323-88 Township Road 394
Red Deer County, Alberta
T0M 0J0 Canada

LAWRENCEBURG BRANCH
408 Commerce Way
Lawrenceburg, Tennessee
38456 USA

DISENGAGING ATTACHMENT FROM COUPLER

UNLOCKING COUPLER TO DROP ATTACHMENT

STEP 1:

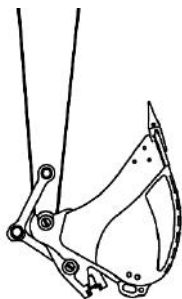

To unlock the coupler to get it ready to drop off the attachment, the first thing that will need to be done is curl the coupler and attachment all the way in, as shown in the picture to the left.

STEP 2:

CRAIG HYDRAULIC KIT

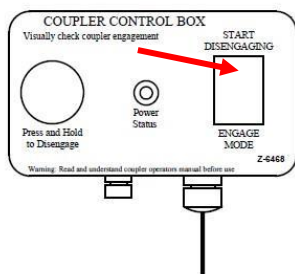

Once the coupler is curled all the way in, flip the rocker switch to “START DISENGAGING”, as shown in the picture to the left. **At this time, the buzzer will start sounding constantly, and the button will light up.**

STEP 3:

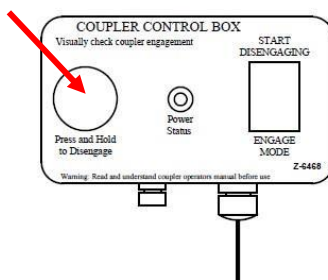

Within 5 seconds of flipping the rocker switch, press and hold the disengage button for at least 2 seconds (see picture to the left). **The buzzer will start to beep once every second, and the button will start flashing.** Hold the bucket curl cylinder over relief for at least 5 seconds until you see the coupler fully unlock.

NOTE: The control box will lock out if you wait longer than 5 seconds to hit the button. If that happens, flip the rocker switch back to “ENGAGE MODE”.

HARLTAND BRANCH
96 McLean Avenue
Hartland, New Brunswick
E7P 2K5 Canada

CAMBRIDGE BRANCH
315 Thompson Drive
Cambridge, Ontario
N1T 2B3 Canada

BLACKFALDS BRANCH
27323-88 Township Road 394
Red Deer County, Alberta
T0M 0J0 Canada

LAWRENCEBURG BRANCH
408 Commerce Way
Lawrenceburg, Tennessee
38456 USA

COUPLER UNLOCKED AND DISENGAGING FROM ATTACHMENT

STEP 5:

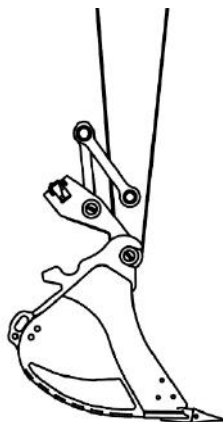

Lower the attachment close to the ground and curl the coupler out. At this point, the rear of the coupler should come free from the attachment. (See picture to the left)

STEP 6:

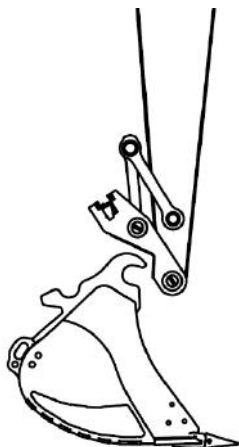

Once the rear of the coupler is free from the attachment, continue to curl the coupler all the way out. Now, pull the front bosses of the coupler out of the front wedge lock hooks. Sometimes this is easiest to do by curling the stick in and dropping the boom. (See picture to the left)

CRAIG HYDRAULIC KIT

STEP 7:

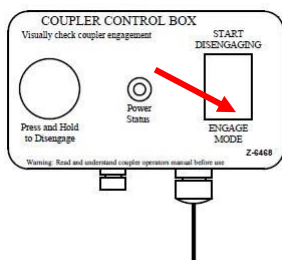

Lastly, once the coupler is free from the attachment. Flip the rocker switch to "ENGAGE MODE", see picture to the left. **Once the rocker switch is flipped, the buzzer will shut off and the control box will revert to idle mode.**

HARLTAND BRANCH
96 McLean Avenue
Hartland, New Brunswick
E7P 2K5 Canada

CAMBRIDGE BRANCH
315 Thompson Drive
Cambridge, Ontario
N1T 2B3 Canada

BLACKFALDS BRANCH
27323-88 Township Road 3008
Red Deer County, Alberta
T0M 0J0 Canada

LAWRENCEBURG BRANCH
3008 Commerce Way
Lawrenceburg, Tennessee
38456 USA